



Growing Trays – Ref. 60 ME



Perspective View



Detail

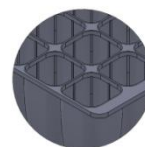
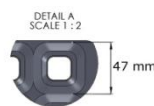
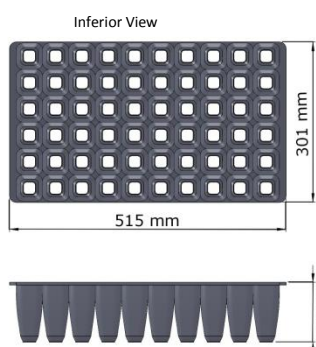

Technical Drawings

Characteristics

Dimensions:

- height: 110mm
- length: 515mm
- width: 301mm

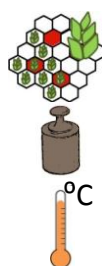

- Plants by m²: 400
- Volume/cell: 160 cm³
- Weight: 1,099kg
- Color: black (for other colors, contact us)
- Warranty: 5 years
- Temperature (sterilization): until 130°C

Application



FORESTRY – FRUITICULTURE – ORNAMENTAL
Forest Plants

More Information:



Transport



Quantity / Palet (Container): 400
Quantity / Palet (Truck)¹: 448

¹ - For trucks with 2,30 m height